

Claverham Road

FISHPONDS

APPROXIMATE FLOOR AREA
93 SQM / 1001 SQFT



GROUND FLOOR
532 sq.ft. (49.4 sq.m.) approx.



1ST FLOOR
469 sq.ft. (43.6 sq.m.) approx.

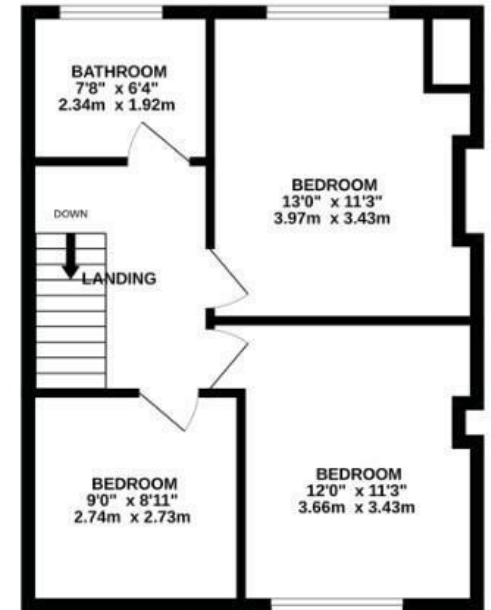

Boardwalk

Claverham Road

FISHPONDS, BRISTOL

£

£395,000



BS16 2HT

zzz

3 Bedrooms



1 Bathrooms

I have rented this property for a while now and it has been a great home for my tenants and a great income for me. The house has been recently refurbished and is a modern three bedroom home.'

